

2022-23

LaMuth Middle School

Orientation



6700 Auburn Road
Concord Township, OH 44077
(440) 354 - 4394
www.riversidelocalschools.com

LaMuth Middle School

Administrative Staff and General Information

Main Office (440) 354-4394
Fax: (440) 354-8218
School Day: 8:00 a.m. - 3:05 p.m.

Office Staff: Joyce Bythway & Valerie Keener

Principal: Mike Lewis michael.lewis@riversideschools.net
Asst. Principal: Alison Hardy alison.hardy@riversideschools.net

Guidance Counselors: Grade 6: Erin Falvey erin.falvey@riversideschools.net
Grade 7: Kathy Francis: kathy.francis@riversideschools.net

Riverside Local Schools website: <https://www.painesville-township.k12.oh.us/>

Riverside Local Schools District Calendar: <https://www.painesville-township.k12.oh.us/Calendar1.aspx>

Locker Assignments: Please check your [schedule](#) via [Infinite Campus](#). Locker numbers can be found in the hallway near the student's advisory classroom.

School Supply Lists: Please check [website](#)
https://www.painesville-township.k12.oh.us/lamuthmiddleschool_home.aspx

Student Handbook: Please check [website](#)
<https://www.painesville-township.k12.oh.us/Downloads/2022-2023%20LMS%20Student%20Handbook%20Final%208-2-2022.pdf>

LaMuth Middle School Bell Schedule

Homeroom	8:00-8:20		
Period 1	8:20-9:09		
Period 2	9:12-10:01		
Period 3-4-5	Grade 6	Grade 7	
	Period 3A 10:04-10:34	Period 3	10:04-10:53
	Period 3B 10:34-11:04	Period 4	10:56 - 11:45
	Period 3C 11:04-11:34	Period 5A	11:48-12:18
	Period 4 11:37-12:26	Period 5B	12:18-12:48
	Period 5 12:29-1:18	Period 5C	12:48-1:18
Period 6	1:21-2:11		
Period 7	2:14-3:05		
Dismissal	3:05-3:15		



LaMuth Middle School Building Map

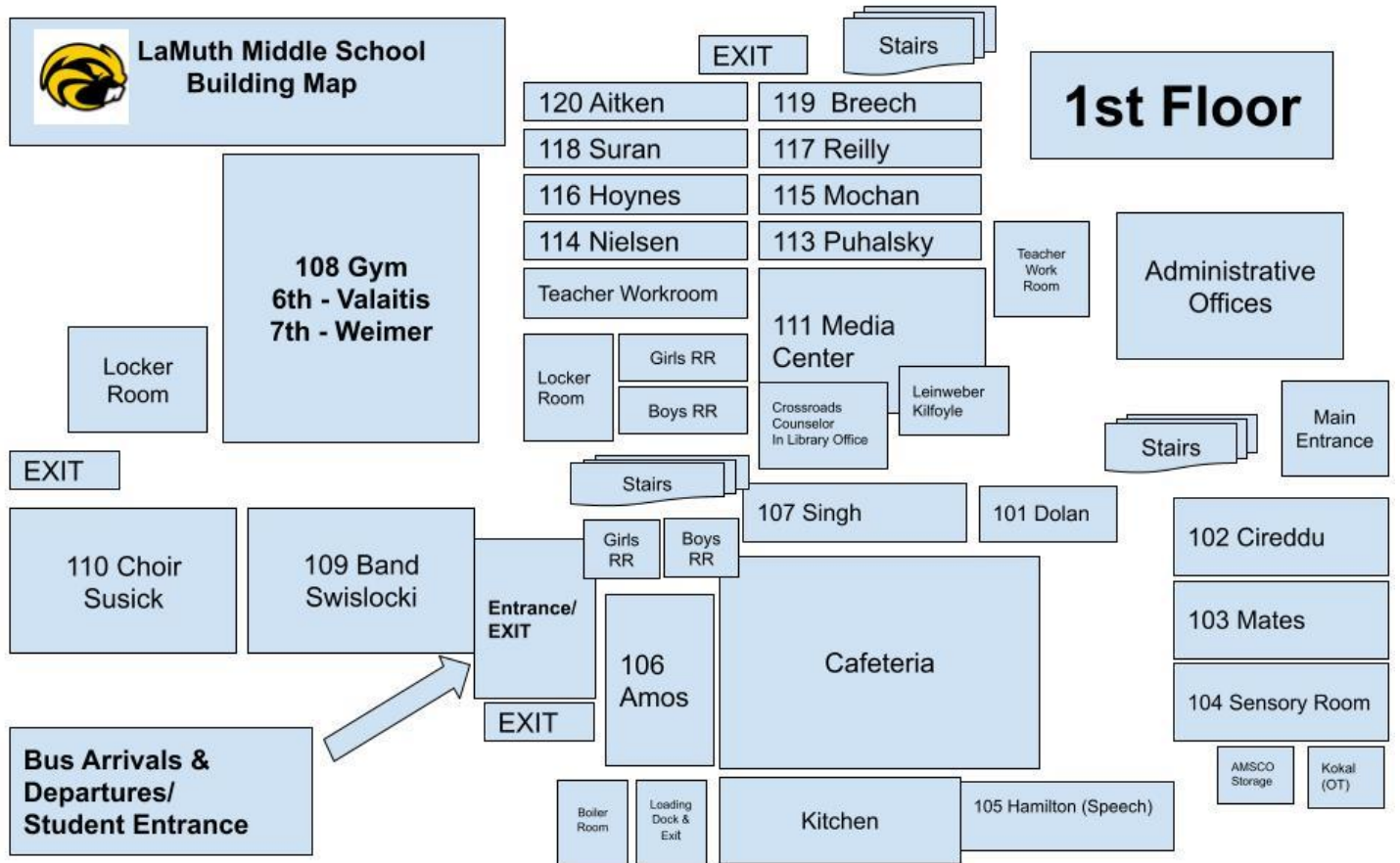

LaMuth Middle School

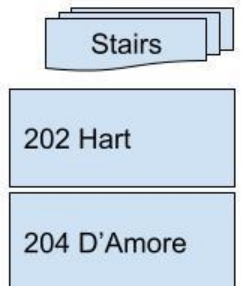
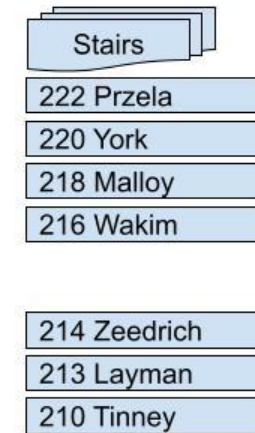
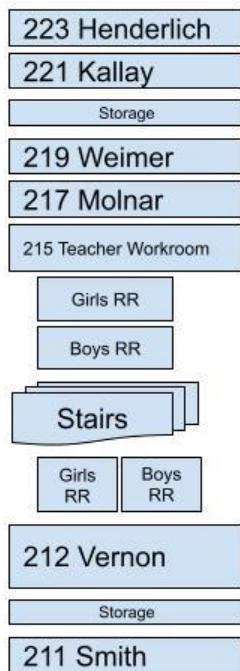

Locker Cheat Sheet- How to Open the Combination Lock:

How to open your locker

Step 1: Turn the knob to the right, passing the zero twice. After passing the zero twice, continue going to the right until you come to your first number.

Your first number is _____



Step 2: Now turn the knob the opposite direction (left) and pass up your first number one time. After passing your first number, continue going left until you come to your second number.

Your second number is _____



Step 3: Now turn the knob back to the right and stop on your third number immediately. ***Do not pass your number at this step!

Your third number is _____



Google & Chromebook Logins: Username: _____

Password: _____

Infinite Campus Login:

Username: _____

Password: _____

LaMuth Pick Up and Drop Off Information 2022-23 School Year

Parents and Guardians,

Please follow this very important plan for dropping off or picking up a child from LaMuth Middle School.

***Please see the attached overhead map**

DROP-OFF

- Use the northernmost entrance only. The other is for buses only.
- No one should be dropped off before 7:40 AM at the earliest. Doors will remain locked until that time. After 7:40, students will wait in the cafeteria until the first bell at 8:00 AM.
- When dropping off, **pull all the way to the end of the sidewalk** as indicated on the map.
- Drop off students at the end of the sidewalk and pull forward or out.
- If the front is full (this rarely happens in the morning), continue north or south on Auburn Road and ride around the Ellison Creek housing development and come back. (this only takes a few minutes at most and keeps our children safe).
- Use one lane only nearest the sidewalk. The double arrows on the map indicate two lines for pick up time only.
- Always give buses the right of way if they are pulling in or leaving. If you cannot stay out of the way of a bus pulling in, please wait.
- Watch for the deputy directing traffic when pulling out.

PICK-UP

- **The parking lot is not to be used at all.** This is for BUSES ONLY this time of day for safety reasons.
- When picking up, **pull all the way to the end of the sidewalk** as indicated on the map.
- Pick up students will be dismissed at approximately 3:03 PM. Students will come out to find their ride.
- **No one should be stopped on Auburn Road.** Once again if the area is full, drive north or south to the Ellison Creek housing development that completes a circle around the LaMuth property and then come back. **Students are NOT permitted to walk out to the street.** You must be in the circle out front.
- Always give buses the right of way if they are pulling in or leaving. If you cannot stay out of the way of a bus pulling in, please wait.
- Watch for the deputy directing traffic when pulling out.

Let's all work together to keep our students safe.

